

REV.	REVISION DESCRIPTION	REDRAWN	APPROVED
*		*	*

FPFB FM04  
FENDER MOUNT  
(SOLD SEPARATELY)

DYNA STYLE WITH  
OPTIONAL UNIVERSAL FPFB FM04  
FENDER MOUNTING BRACKET

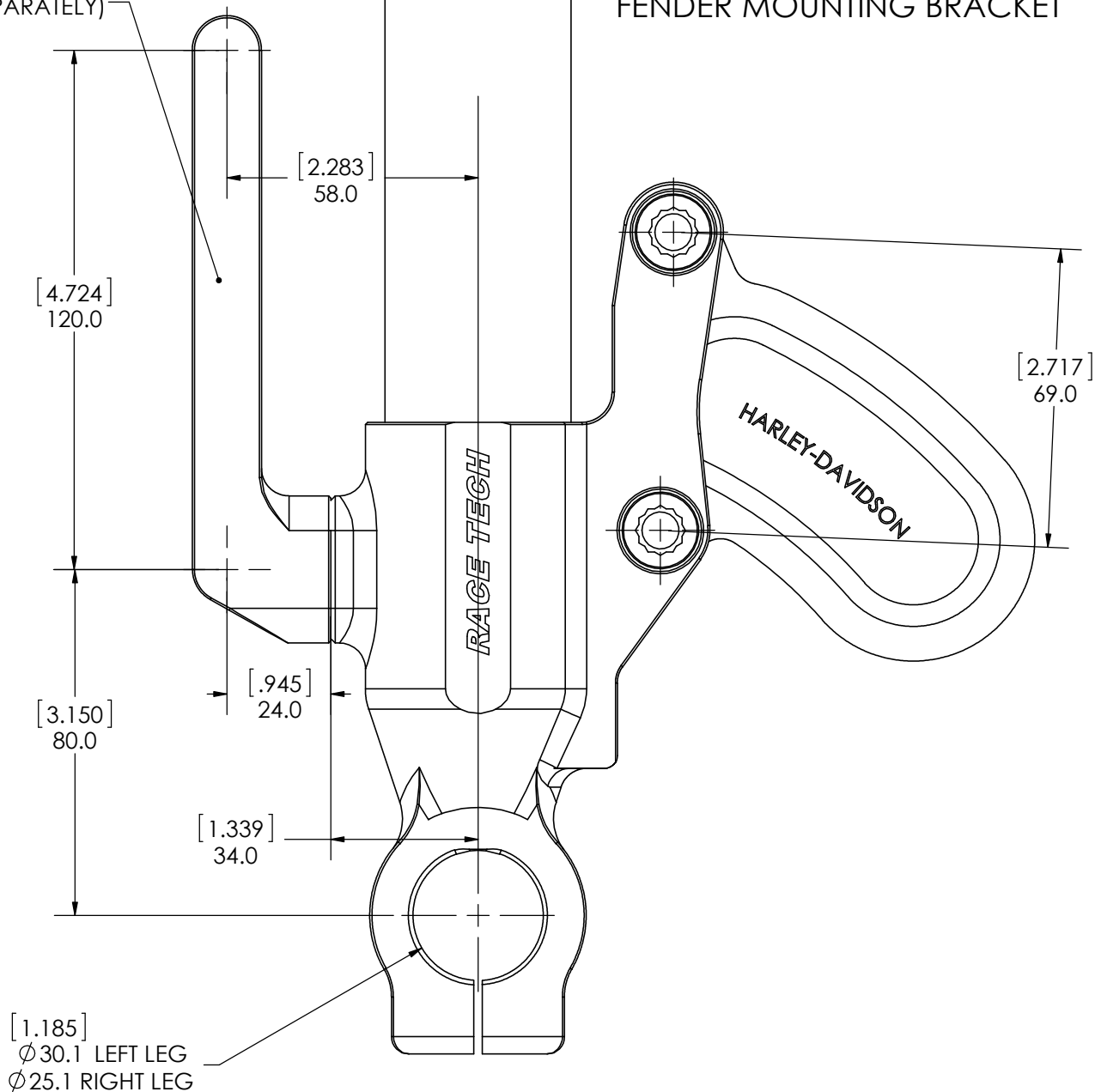

TOLERANCES: Dimensions are in  
0 = ± .5 MILLIMETERS [IN]  
0.0 = ± .1 unless specified  
0.00 = ± .05

The information contained in this drawing is the sole property of Race Tech. Any reproduction in part or whole without written permission is prohibited.

**RACE TECH**

1501 Pomona Road, Corona, CA 92880  
951.279.6655 fax: 951.279.7171

RT G6 FORK ASSY FOR DIMS - DYNA STYLE

MATERIAL: *	DRAWN: PT 3-6-14	SCALE:1:10	PART NO. *	FINISHED P/N *	DWG. NO. *	REV. *
FINISH: *	APPROVED: *	SHEET 1 OF 5	FILE			
COLOR: *	ECR#: *		G6 FORK BOTTOM ASSY DYNA.slddrw			

# LEFT BACK VIEW

REV.	REVISION DESCRIPTION	REDRAWN	APPROVED
*	*	*	*

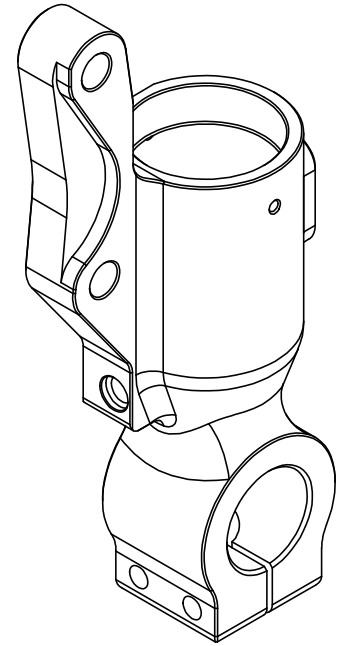
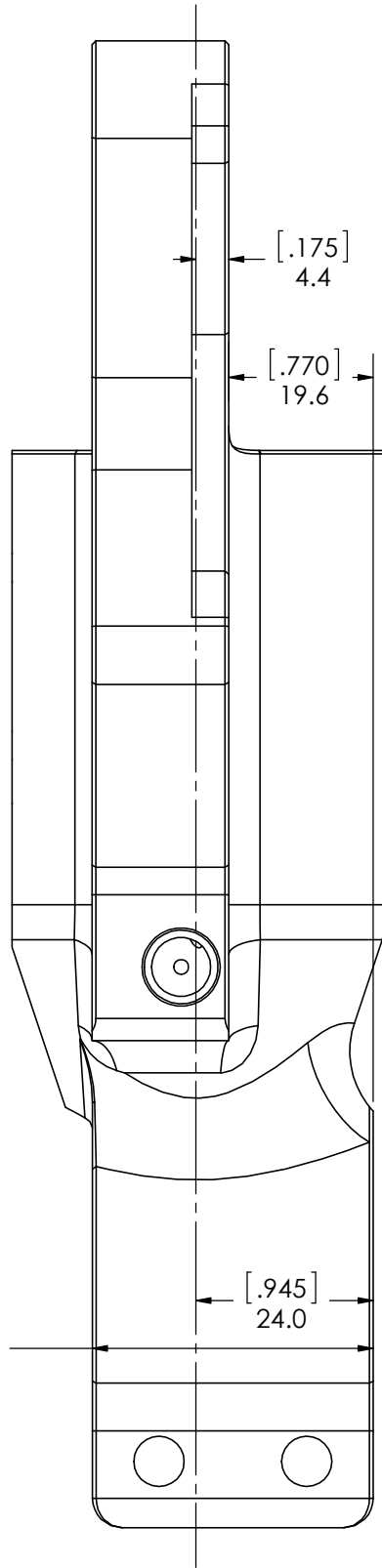

TOLERANCES: Dimensions are in MILLIMETERS [IN] unless specified  
 0 = ± .5  
 0.0 = ± .1  
 0.00 = ± .05

The information contained in this drawing is the sole property of Race Tech. Any reproduction in part or whole without written permission is prohibited.

## RACE TECH

1501 Pomona Road, Corona, CA 92880  
 951.279.6655 fax: 951.279.7171

### FK BOTTOM 43 RT 14 DYNA- LEFT

MATERIAL:	6061-T6 ALUMINUM	DRAWN:	PT 3-5-14	SCALE:1:10	PART NO. FPFB S43004L	FINISHED P/N	DWG. NO.	REV.
FINISH:	HARD-ANODIZE	APPROVED:		SHEET 2 OF 5	FILE G6 FORK BOTTOM ASSY DYNA.slddrw		2203	C
COLOR:	BLACK	ECR#:						

REV.	REVISION DESCRIPTION	REDRAWN	APPROVED
*	*	*	*

# LEFT FRONT VIEW FENDER MOUNT BOSS

USE (2) M5 x .8 x 10L ALLEN  
BOLTS TO ATTACH FENDER  
MOUNT BRACKET

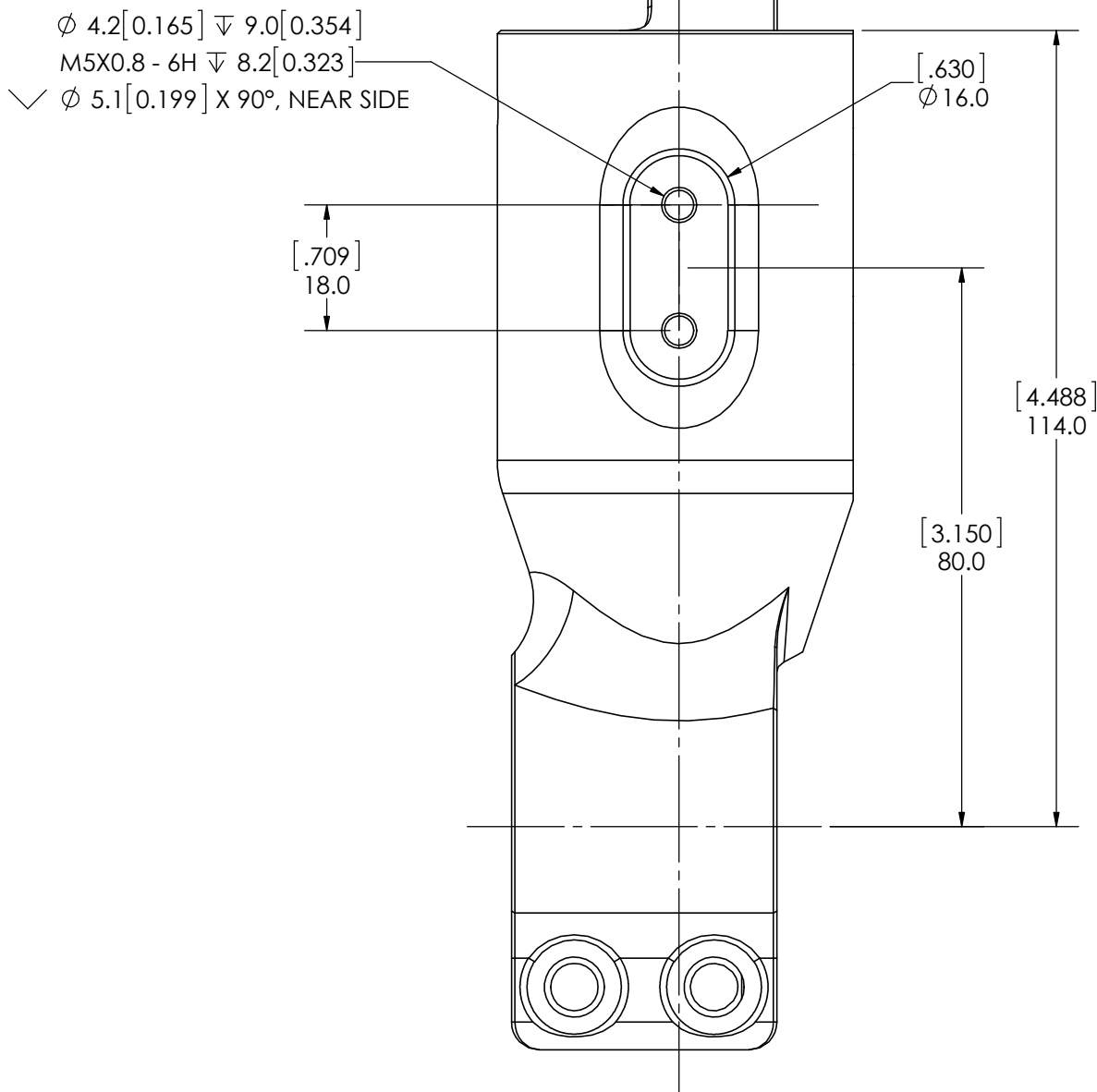

TOLERANCES: Dimensions are in  
0 =  $\pm .5$  MILLIMETERS [IN]  
0.0 =  $\pm .1$  unless specified  
0.00 =  $\pm .05$

The information contained in this drawing is the sole property of Race Tech. Any reproduction in part or whole without written permission is prohibited.

## RACE TECH

1501 Pomona Road, Corona, CA 92880  
951.279.6655 fax: 951.279.7171

### FK BOTTOM 43 RT 14 DYNA- LEFT

MATERIAL:	6061-T6 ALUMINUM	DRAWN:	PT 3-5-14	SCALE:1:10	PART NO. FPFB S43004L	FINISHED P/N	DWG. NO.	REV.
FINISH:	HARD-ANODIZE	APPROVED:		SHEET 3 OF 5	FILE G6 FORK BOTTOM ASSY DYNA.slddrw		2203	C
COLOR:	BLACK	ECR#:						

REV.	REVISION DESCRIPTION	REDRAWN	APPROVED
*	*	*	*

RIGHT BACK VIEW  
 OPTIONAL BRAKE  
 MOUNTING BOSS  
 MIRROR OF LEFT FORK BOTTOM

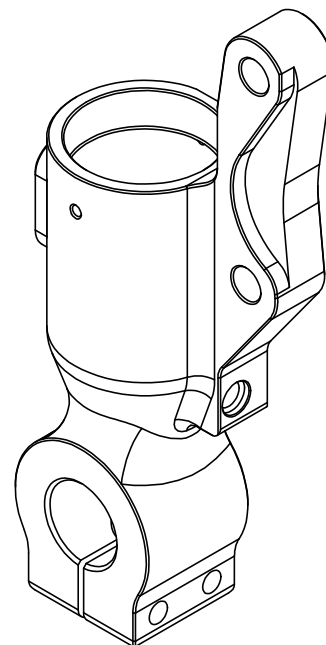
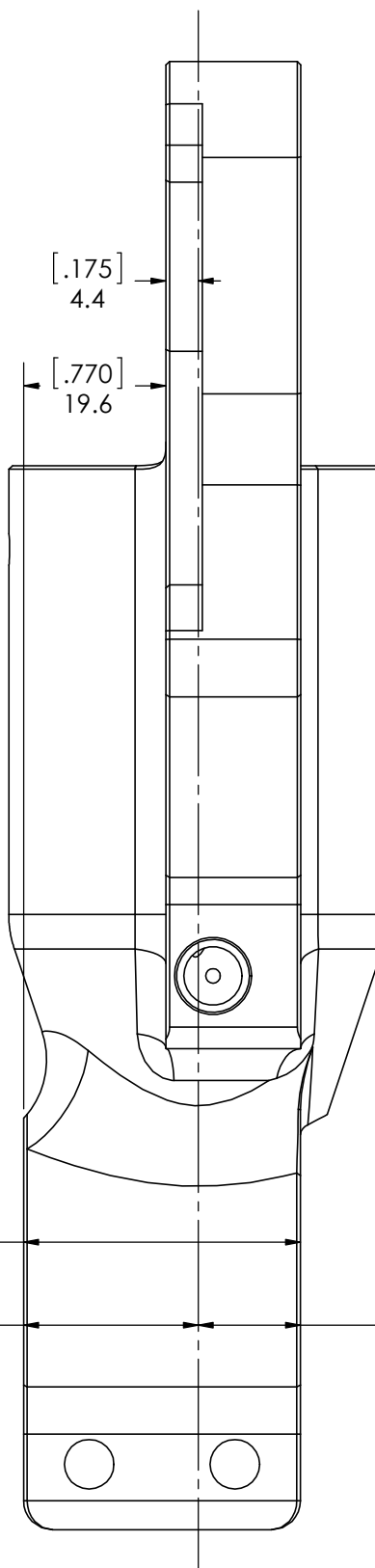

TOLERANCES: Dimensions are in  
 0 = ± .5 MILLIMETERS [IN]  
 0.0 = ± .1 unless specified  
 0.00 = ± .05

The information contained in this drawing is the sole property of Race Tech. Any reproduction in part or whole without written permission is prohibited.

**RACE TECH**

1501 Pomona Road, Corona, CA 92880  
 951.279.6655 fax: 951.279.7171

FK BOTTOM RT43 DYNA RIGHT - DUAL DISK

MATERIAL:	6061-T6 ALUMINUM	DRAWN:	PT 3-8-14	SCALE:1:10	PART NO. FPFB S43004R2	FINISHED P/N	DWG. NO.	REV.
FINISH:	HARD-ANODIZE	APPROVED:		FILE	G6 FORK BOTTOM ASSY DYNA.slddrw		2105	C
COLOR:	BLACK	ECR#:		SHEET 4 OF 5				

REV.	REVISION DESCRIPTION	REDRAWN	APPROVED
*	*	*	*

# RIGHT BACK VIEW NO BRAKE

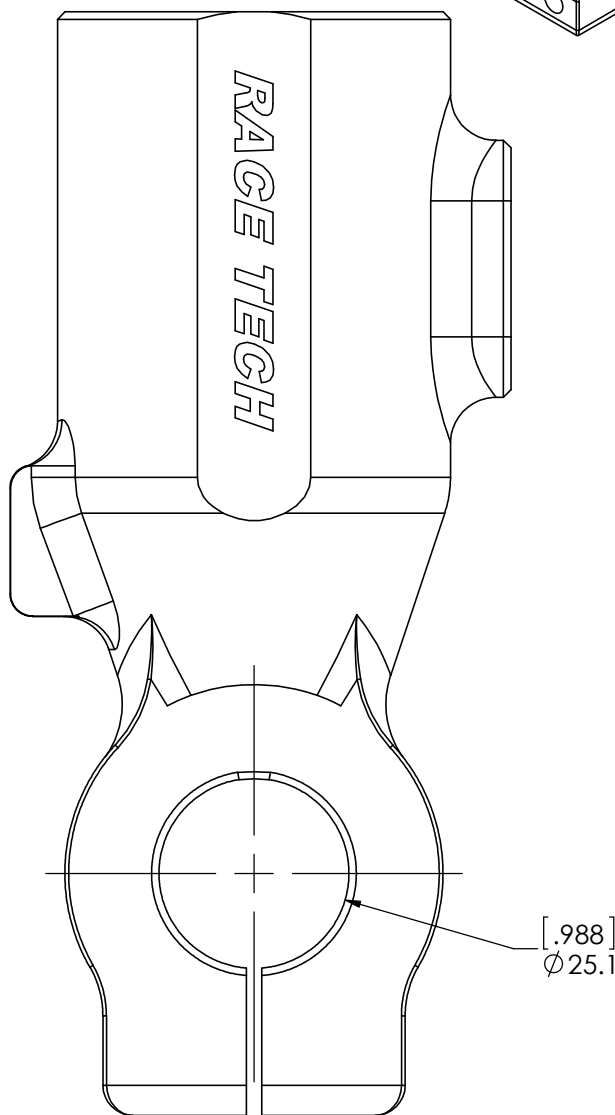
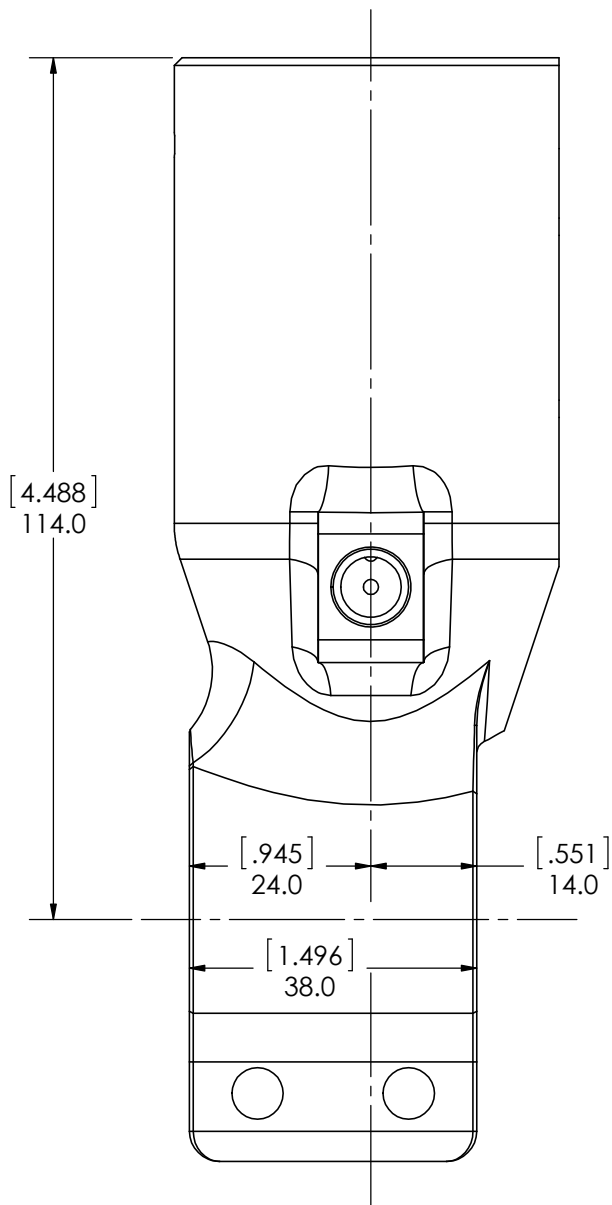
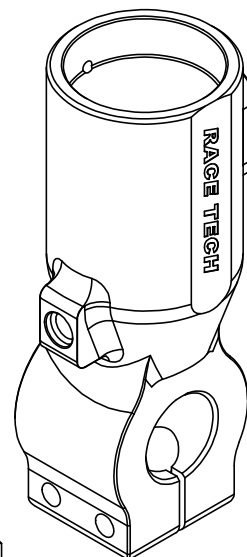

TOLERANCES: Dimensions are in MILLIMETERS [IN] unless specified  
 0 = ± .5  
 0.0 = ± .1  
 0.00 = ± .05

The information contained in this drawing is the sole property of Race Tech. Any reproduction in part or whole without written permission is prohibited.

**RACE TECH** 1501 Pomona Road, Corona, CA 92880  
 951.279.6655 fax: 951.279.7171

## FK BOTTOM 43 RT 14 DYNA - RIGHT

MATERIAL:	6061-T6 ALUMINUM	DRAWN:	PT 3-5-14	SCALE:1:10	PART NO. FPFB S43004R	FINISHED P/N	DWG. NO. 2204	REV. C
FINISH:	HARD-ANODIZE	APPROVED:		SHEET 5 OF 5	FILE G6 FORK BOTTOM ASSY DYNA.slddrw			
COLOR:	BLACK	ECR#:						